



italtec

Company with Quality
System Certified by DNV
ISO 9001/2000

E.M.M.S. 0,3 KW ACCESSORIES

MOD.3182 Digital Tachometer

The meter is a digital photo tachometer. Measuring rpm is safe and accurate without attachment to object. It has had wide measuring range and high resolution. The last value/max. value/min. value will be automatically stored in memory and can be obtained by pressing memory call button.

- Test Range: 5 ~ 99999 RPM \pm 0.05%
- Sampling Time: 1 sec. (over 60 RPM)
- Test range select: Automatic
- Memory: Last value, Max. value, Min. value
- Detecting distance: 50~150mm/2~6 inch (max. 300mm/12inch)
- Max. display / LCD size: 99999 / 18.5 X 48mm
- Dimension: 72 X 190 X 38mm
- Weight: 250g

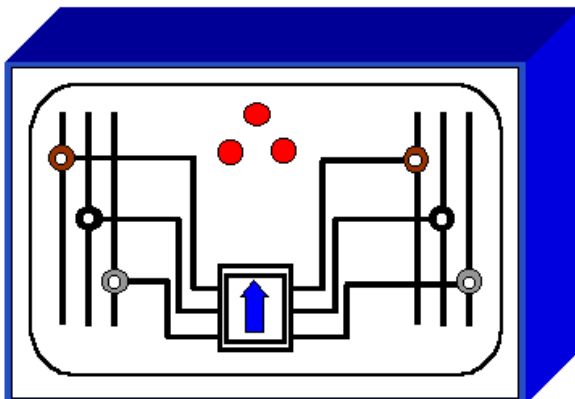

MOD.3184 Synchronising Module

This module includes three indicator lamps, three magnetothermal circuit breakers, a tripolar switch and standard colour coded banana sockets.

This module allows to see the synchronism between two generators when are shunt connected between them or when a generator is shunt connected to the main network.

- Weight: 2kg.
- Operative voltage: 208/380/415V
- Dimensions: LxWxH: 25x27x15cm

MOD.3185 Digital Speed Meter

This module

- Output: 1V/1000 rpm
- Internal resistance: 60 ohm
- Inputs/outputs: 4mm safety sockets
- Unit type: table-top unit
- Dimensions: LxWxH: 25x27x15cm
- Weight: 3kg.



Copyright © italtec s.r.l. All Rights Reserved

Ci riserviamo di apportare modifiche e migliorie senza preavviso
We reserve the right to change these specifications without notice
Photos et données techniques susceptibles de modifications sans avis

ITALTEC S.R.L. SISTEMI TECNICI DIDATTICI
20090 FIZZONASCO MI (Italy) – Via privata Liguria, 3
Tel. +39 02-90.721.606 Fax. +39-02-90.720.227
e-mail: italtec@italtec.it <http://www.italtec.it>



italtec

Company with Quality
System Certified by DNV
ISO 9001/2000

E.M.M.S. 0,3 KW ACCESSORIES

MOD.3196

Connection Leads Set

This set consists of 30 leads in 3 different coded colours and lengths chosen to allow the realisation of all experiments provided in the manual.

Leads are capable of 15A current intensity and are terminated on banana-banana plugs. This set includes also the storage rack.

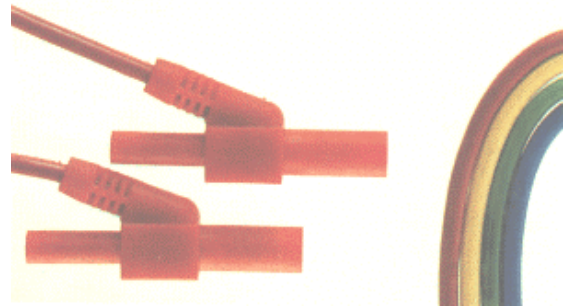

MOD.3215

Gear block

Adjustment device for the rotor of the three-phase asynchronous motor with slip-ring rotor for use as rotary transformer

Design: manually-actuated adjustable gear, complete with base plate.

- Coupling type: cog coupling;
- Unit type: table-top unit
- Dimensions LxWxH 16x 14 x 15cm;
- Weight: 1,5kg

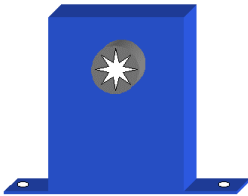

MOD.3212

Shaft end guard

- Dimensions: LxWxH: 3 x 9 x 11,5cm;
- Weight: 0,094 kg

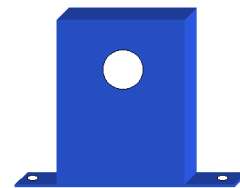

MOD.3213

Coupling guard

- Dimensions: LxWxH: 6 x 9 x 11,5cm;
- Weight: 0,139 kg

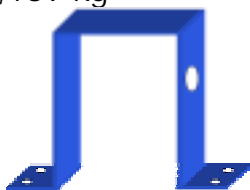

MOD.3214

Rubber coupling sleeve

- Design: internal gear rim.
- Material: rubber
- Dimensions: 40x45 (length x diameter);
- Weight: 0,036kg



Copyright © italtec s.r.l. All Rights Reserved

Ci riserviamo di apportare modifiche e migliorie senza preavviso
We reserve the right to change these specifications without notice
Photos et données techniques susceptibles de modifications sans avis

ITALTEC S.R.L. SISTEMI TECNICI DIDATTICI
20090 FIZZONASCO MI (Italy) – Via privata Liguria, 3
Tel. +39 02-90.721.606 Fax. +39-02-90.720.227
e-mail: italtec@italtec.it <http://www.italtec.it>